

8 Threaded mounting holes both ends
 M10-1.5 x 0.6" Deep
 4 on 4.02" BCD
 4 on 1.5 x 4.02 Rectangular pattern

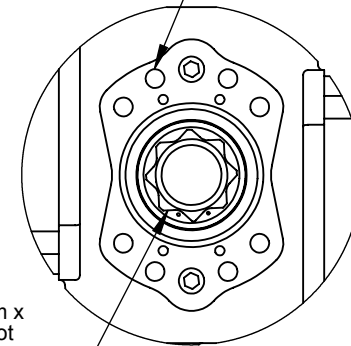

DETAIL B
 SCALE 1 : 4

Double square female shaft geometry on both ends. 1.42" Square x 1.5" Dp (36mm x 38mm). The side of the actuator that is not attached to the valve will be provided with a NAMUR Top Hat to convert the female shaft to a male NAMUR #1 slotted drive geometry. Both ends are drilled and tapped for a NAMUR 1 mounting pattern or 30mm x 80mm using M5 x 9mm Dp screw threads.

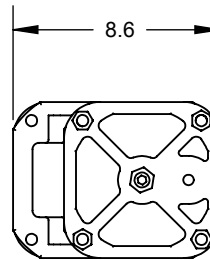
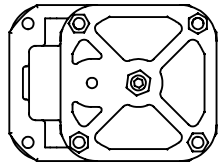

DIMENSIONS ARE IN INCHES TOLERANCES except as shown		NAME	DATE
FRACTIONAL: ±		EH	4/18/09
ANGULAR: ±		Rev B	
2 PLACE DECIMAL: ±		Rev C	
3 PLACE DECIMAL: ±		Rev D	
		Rev E	
MATERIAL			
PROCESS			
DO NOT SCALE DRAWING			

PROPRIETARY AND CONFIDENTIAL
 THE INFORMATION CONTAINED IN THIS DRAWING IS THE SOLE PROPERTY OF QTRCO, INC. ANY REPRODUCTION IN PART OR AS A WHOLE WITHOUT THE WRITTEN PERMISSION OF QTRCO, INC. IS PROHIBITED.

QTRCO, Inc.	
Dimensional Drawing QD and QS10DA	
SIZE A	DWG. NO. QD10DA-DIM-001A
WEIGHT (Pounds): 53	SHEET ____ OF ____ 1 of 1 if not shown